



VOLT® Low Voltage Landscape Lighting
VOLT® Cast Brass Integrated LED Downlight
VAL-91xx Series

Help Hotline:

1-813-978-3700 • Mon-Fri 8am-8pm • Sat-Sun 10am - 6pm (EST)

Specifications and product details subject to change without notice.
© Copyright 2017, VOLT® Lighting, Lutz FL USA 33549 • All rights reserved.
customersupport@voltlighting.com • 813.978.3700



! Important Safety Instructions: Read Before Installation

This luminaire is intended for installation in accordance with local codes and the National Electric Code (NEC). Failure to adhere to these codes and instructions may result in serious injury, property damage and void the warranty.

These instructions do not intend to cover all variations in installation, operation maintenance or mounting situation.

1. Make sure that the power is turned OFF before installing or servicing this luminaire.
2. Warning: risk of electrical shock. Install all luminaires 10 feet (3.05M) or more from pool, spa or fountain.
3. This luminaire is intended to be used only with a power supply (transformer) rated maximum of 300 watts (25 AMPS) at 15 volts.
4. Wiring connections must be made with wire connectors that is suitable for outdoor use.
5. Position the low voltage wire and wire connector so that it is located within 6 inches (15.2 cm) from a building structure, a luminaire, or fitting.
6. The main low voltage cable is intended for shallow burial - less than 6 inches (152 mm)
7. If additional lengths of low voltage cable is required, please contact www.voltlighting.com or call 1-813-978-3700.

SAVE THESE INSTRUCTIONS

Package Contents

- A. (1) Luminaire
- B. (1) Base
- C. (3) Spacer

- D. (3) Self-tapping Screw
- E. (1) Optic*

* Ships with a 60° installed.

Product Dimensions

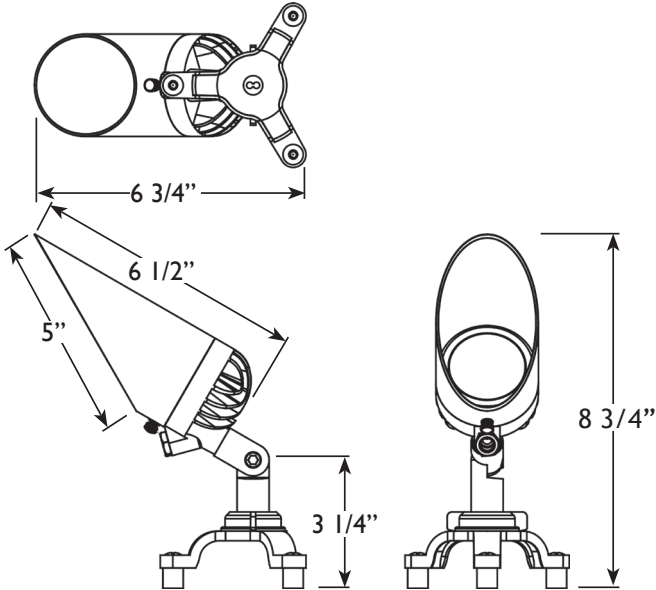

1 Install Base

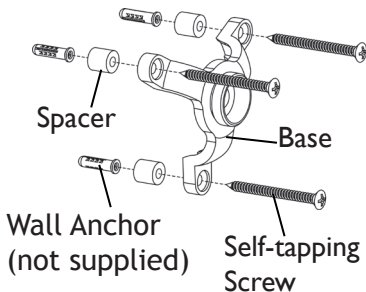

Determine the desired location for mounting the luminaire. Pass self-tapping screws through the holes on the base and spacers. Thread the self-tapping screws into the surface to secure the base.

NOTE: Wall anchors (not supplied) are required for brick walls or concrete walls. To determine locations for wall anchors place the base onto your desired location and mark points from holes on base.



2 Install Luminaire to Base

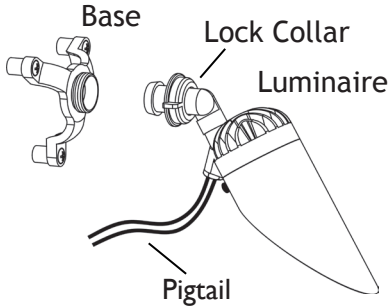

Place the luminaire on top of the base and secure with lock collar. Tighten until snug.

3 Wire Connections

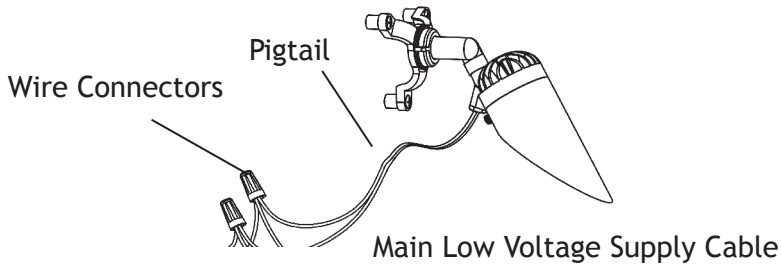

Strip both of the leads from the luminaire pigtail. Using two wire connectors (sold separately), connect the leads from the luminaire to the main low voltage supply cable leads.

Install/Replace Optic

4 Remove Glare Guard

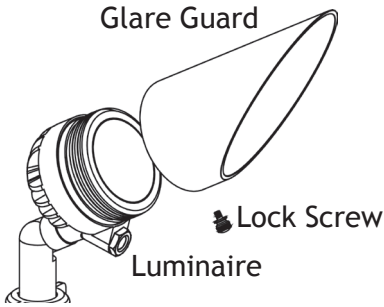

Unscrew the lock screw and remove the glare guard from the luminaire.

5 Remove Outer Ring

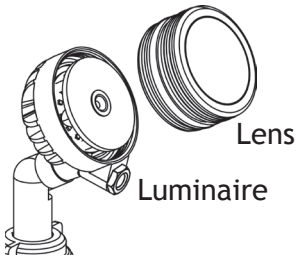

Unscrew the lens and remove it from the luminaire.

6 Replace Optic

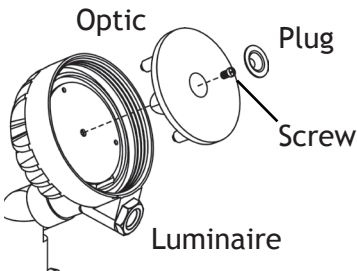

Remove the plug at the center of the optic. Unscrew the screw and remove the optic from the luminaire.

Install the new optic in the luminaire. Reverse Steps 6 and Step 4 to reinstall removed parts.



Help Hotline:

1-813-978-3700 • Mon-Fri 8am-8pm • Sat-Sun 10am - 6pm (EST)

Specifications and product details subject to change without notice.
© Copyright 2017, VOLT® Lighting, Lutz FL USA 33549 • All rights reserved.
customersupport@voltlighting.com • 813.978.3700

www.voltlighting.com

is-val-91xx-ver6